



# Checkfluid Oil Sampling Solutions

For Pressurized & Non-Pressurized Sampling



**ZUDAK**  
SOLUTIONS

**Provided by Zudak Solutions**

Email: [support@zudaksolutions.com](mailto:support@zudaksolutions.com)  
Tel: 678-383-5479



## Contents

Why Use Sampling Valves?	3	<b>Condition Monitoring Tools</b>	<b>18</b>
<b>Sampling Valves</b>	<b>4</b>	AB Breather Mount	19
KP Pushbutton	5	AB Breather Mount Accessories	20
KP Pushbutton - Engine Sampling Kits	6	Oil Mist Coalescer (OMC)	20
LP Pushbutton	7	Filter Minder™	20
KST Series	8	Desiccant Breather	20
B Series	9		
L Series	10	AD Drain Mount	21
LE Series	11	AC Mount	22
<b>Mounting Options</b>	<b>12</b>	AD & AC Mount Accessories	23
Inline Connectors	12	Oil Level Gauges	23
Port Adapters	12	Bottom Sediment & Water Bowl	23
Tees	12	3D Sight Glass	23
<b>Sampling Tubes</b>	<b>13</b>	The CORE Solution	24
LT Sampling Tube	14	Drum Adapter	25
LTJ Sampling Tube	15		
LTJ Sight Sampling Tube	16		
BT Sampling Tube	17		

### About Checkfluid

Since 2001 Checkfluid has made it easier for companies to monitor their critical equipment by manufacturing and designing oil sampling valves and related hardware. Checkfluid's sampling valves are designed to make fluid sampling easier. With a Checkfluid sampling valve, you can draw a precise fluid sample from the same spot in the active zone every time.

ISO 9001:2015.

# Why Use Sampling Valves?

For years companies have used oil analysis to determine the health and condition of their equipment. Most recognize the value of using oil analysis to avoid unplanned equipment downtime and for planning oil changes. However, many companies are not getting the most out of their oil analysis program because they do not understand the importance of taking a good oil sample.

Representative and repeatable oil samples are the important first step in any oil analysis program. Without one, the lab would have nothing to analyze. The aim of any predictive oil analysis program is to trend any gradual changes in fluid properties, contaminants and wear debris so that corrective action can be started in a controlled, planned manner. The results from your sample will determine if corrective actions need to be taken. An improper sample can skew these results, producing either costly false negatives or false positives. Ultimately those improper samples can cause an oil analysis program to be abandoned.



**A proper sample represents the true condition of the equipment. It's taken while the equipment is running and it is taken from the same spot every time.**

Sampling valves are the best method for obtaining proper, reliable oil samples. They make it possible to take oil samples safely, while the equipment is running, from the same spot, every time. This means that oil samples can be taken at any time since shutdowns are no longer necessary. Sampling, while the equipment is running, away from the sediment and filters, ensures that the sample is an accurate representation of the equipment's lubrication condition. Additionally, the oil sample is coming from the same spot in the active zone every time. Meaning that the sample pulled will contain hot, information-rich oil that can be trended against previous samples to show the condition of your equipment.

# Sampling Valves

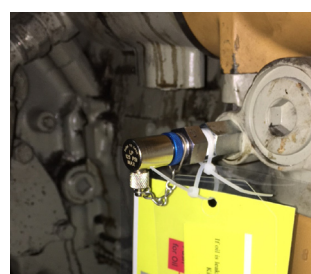
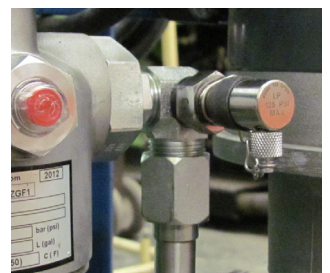
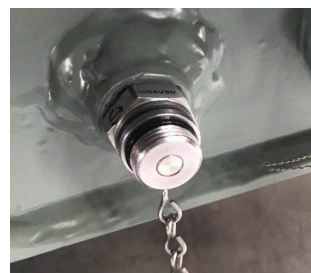

KP Pushbutton

5 - 750 psi (0.03 - 5.17 MPa)

Hydraulics | Engines | Compressors | Transmissions | Coolant | Turbines

Benefits

- **No probes needed**
- Low purge volume
- Patented elastomeric vacuum tight seals
- Automatic valve shut off
- **Remote access available**
- Reliable: dual sealed design independently tested at 7800 psi for one million cycles
- Locknut available for extra protection against high vibration
- Silicone heat protection pad also available

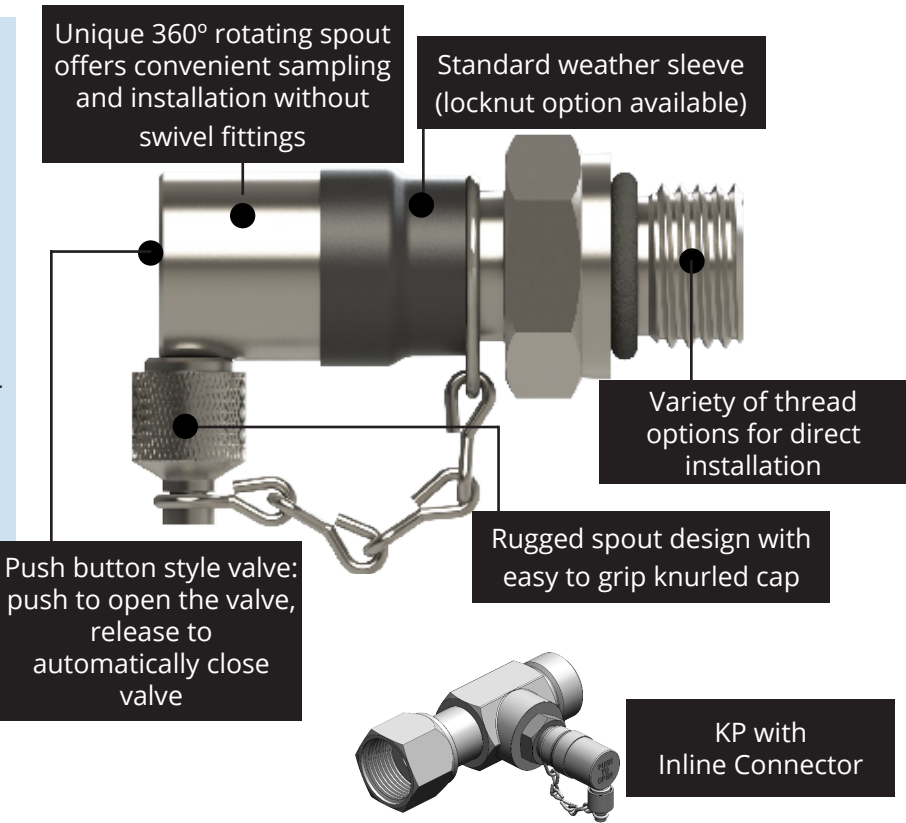

Special Part Number:  
KPQ14NP - for Ammonia and Refrigerant Compressors

Part Number	Locknut or Weathersleeve	Port Thread Size and Type	Valve Sealing	Valve Material
KP14NV	Weathersleeve	1/4"-18 NPTF	Viton	Carbon Steel
KP716UV	Weathersleeve	7/16"-20 ORB	Viton	Carbon Steel

KP with Inline Connector

Part Number	Locknut or Weathersleeve	Port Connections	Valve Sealing	Valve Material
KP-8J-8JF	Weathersleeve	-8 JIC to -8 JIC Fem	Viton	Carbon Steel
KP-12J-12JF	Weathersleeve	-12 JIC to -12 JIC Fem	Viton	Carbon Steel

**Notes:** other thread types and sizes are available

Valve Sealing Options: Nitrile, Viton, Neoprene

Valve Material Options: Carbon Steel, 316 Stainless Steel or Stainless Externals

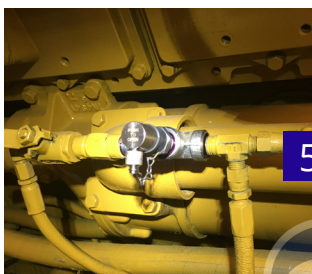

## KP Pushbutton Engine Sampling Kits

There are direct or remote installs available for most engines. In most cases the type of access is dependent on the truck and engine models. If the best sampling port is readily accessible, a direct install will be recommended. If the port is not directly accessible we will recommend a remote access solution which uses a hose assembly to extend from the port to a location it can be mounted.



Engine Make	Engine Model	Style	Direct or Remote	Frequently Used KP Kit or Part #	TB Clamp1 Required?
Cummins	ISX		Direct	KP1415MV	No
Cummins	ISX	Natural Gas	Remote	KP064-A	Yes
Cummins	ISL		Direct	KP18NV	No
Cummins	ISL		Remote	KP067	Yes
Detroit Diesel	DD13		Remote	KP023	No
Detroit Diesel	DD15	113" BBC Daycab	Remote	KP023	No
Detroit Diesel	DD15		Remote	KP022-A	No
International	DT466		Remote	KP083	Yes
Mack	MP7/MP8		Remote	KP071-C	Yes
Mack	MP7/MP8	LR 613 Cab Over	Remote	KP071-E	No
Mack	E7		Direct	KP14NV	No
Paccar	MX13		Remote	KP063-A	Yes
Volvo	D11/D13		Remote	KP071-C	Yes

**Note:** Not all Engines are listed - other frequently used engines kits are available

**Please note we recommend a pilot install for each different truck. As there can be modifications between different truck years or modifications made by owners. A pilot kit ensures it will work for the application.**

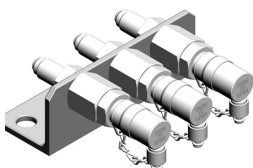

### Sampling Multiple Systems?

- Spend less time gathering samples from multiple systems
- The KP Sampling Point will let technicians sample up to three different systems safely from one convenient location

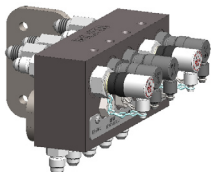

- The SC from Checkfluid relocates all of your system's sampling valves into one easy to access location.
- The SC allows you to draw a highly representative sample through the use of a bypass loop.

## LP Pushbutton

3 - 125 psi (0.02 - 0.86 MPa)

Circulating Lubrication Lines | Filters | Filter Carts Pumps | Bearings | Coolant | Turbines

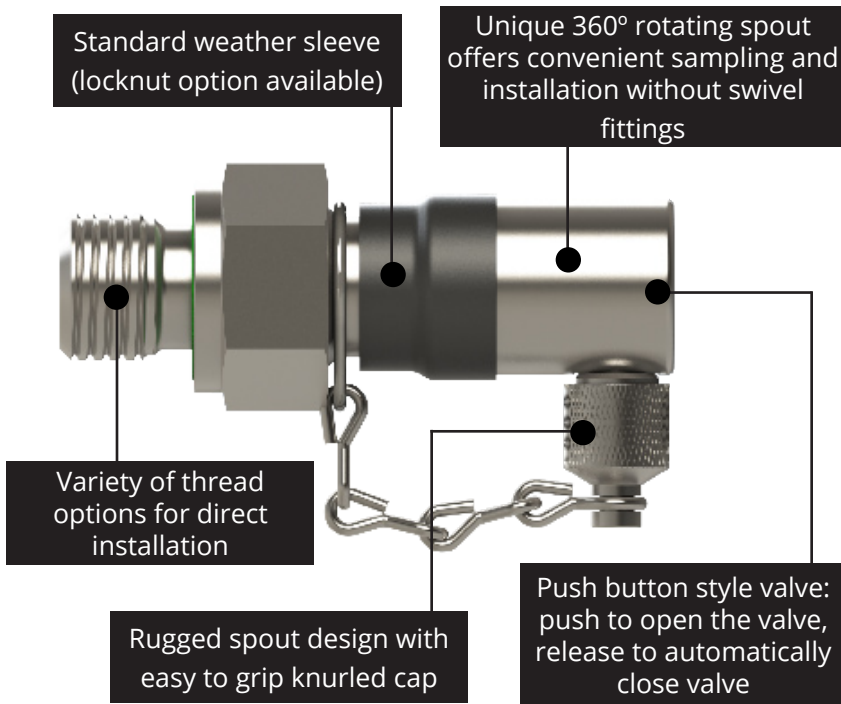

### Benefits

- **No probes needed**
- Low purge volume
- Patented elastomeric vacuum tight seals
- Automatic valve shut off
- **Extra high flow for pressurized high viscosity gear oils up to VG 1000**
- For low-pressure, or low-temperature applications
- Reliable: dual sealed design independently tested at 7800 psi for one million cycles

Part Number	Locknut or Weathersleeve	Port Thread Size and Type	Valve Sealing	Valve Material
LP2N	Weathersleeve	1/8"-27 NPTF	Viton	Carbon Steel
LP4N	Weathersleeve	1/4"-18 NPTF	Viton	Carbon Steel
LPL4N	Locknut	1/4"-18 NPTF	Viton	Carbon Steel
LP4GC	Weathersleeve	1/4" X 19 BSPP	Viton	Carbon Steel
LPL4GC	Locknut	1/4" X 19 BSPP	Viton	Carbon Steel

**Notes:** other thread types and sizes are available

Valve Material Options: Carbon Steel, 316 Stainless Steel

Stainless Steel comes standard with Locknut (add -R to end of part number i.e LPL4N-R)

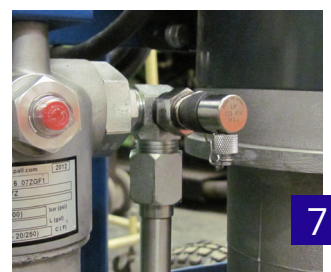

## KST Series

5 - 4000 psi (0.03 - 27.6 MPa)

Hydraulics | Engines | Compressors | Transmissions | Coolant | Turbines

## Benefits

- Low purge volumes
- Patented elastomeric vacuum tight seals
- Can be used for pressure testing
- Reliable: dual sealed design independently tested at 7800 psi for one million cycles
- Popular mobile standard 2mm probe, compatible with SOS, Probalizer and Quick Draw valves
- **Dynamic sampling up to 4000 psi**
- **Note: sampling pressure greater than 750 psi require the VHKF probe**

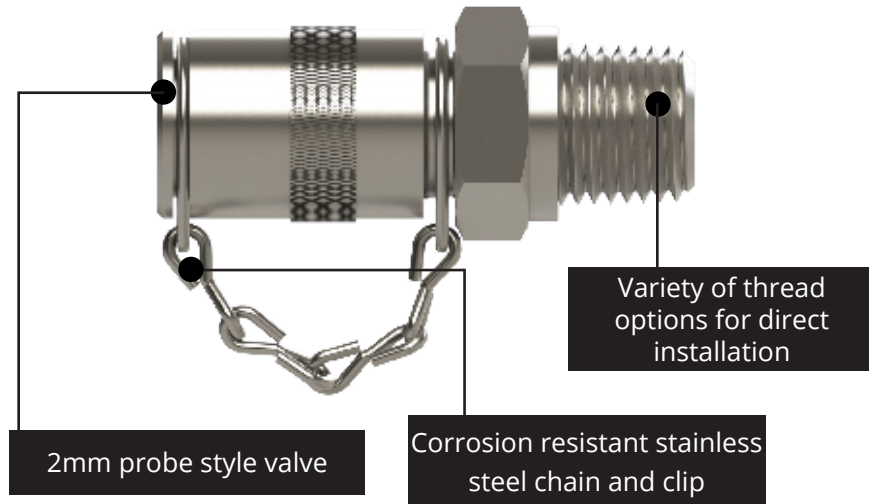

VHKF Sampling Probe

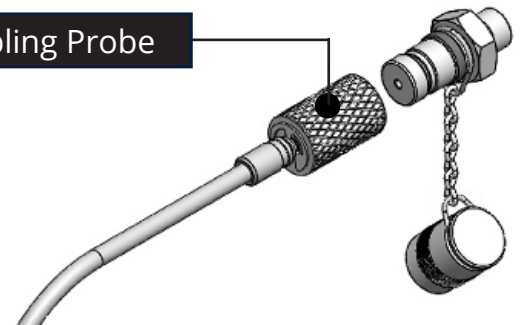

Probe	Use	Reusable?
SVP1	For general sampling (up to 750 psi)	No
KPB4	Pusbutton connection for general sampling (up to 750 psi)	Yes
VHKF	For high pressure sampling (750 - 4000 psi)	Yes
KF-4NF	For pressure diagnostics	Yes

Part Number	Port Thread Size and Type	Valve Sealing	Valve Material
KST14N-VC	1/4"-18 NPTF	Viton	Carbon Steel
KST14NV-RC	1/4"-18 NPTF	Viton	316 Stainless Steel
KST18N-VC	1/8"-27 NPTF	Viton	Carbon Steel
KST716U-VC	7/16"-20 ORB	Viton	Carbon Steel

**Notes:** other thread types and sizes are available

Valve Sealing Options: Nitrile, Viton, Neoprene

Valve Material Options: Carbon Steel, 316 Stainless Steel or Stainless Externals



## B Series

0 - 5800 psi (0 - 40 MPa)

Hydraulics | Gearboxes | Reservoirs

### Benefits

- Euro-Probe sampling valve uses M16x2 probes
- Metal ball and seat valve allows pressure testing to 5800 psi (400 bar), not suitable for air, gas or vacuum

Looking for high pressure sampling?  
Review Checkfluid's vacuum tight,  
patented KST Probe Series valve

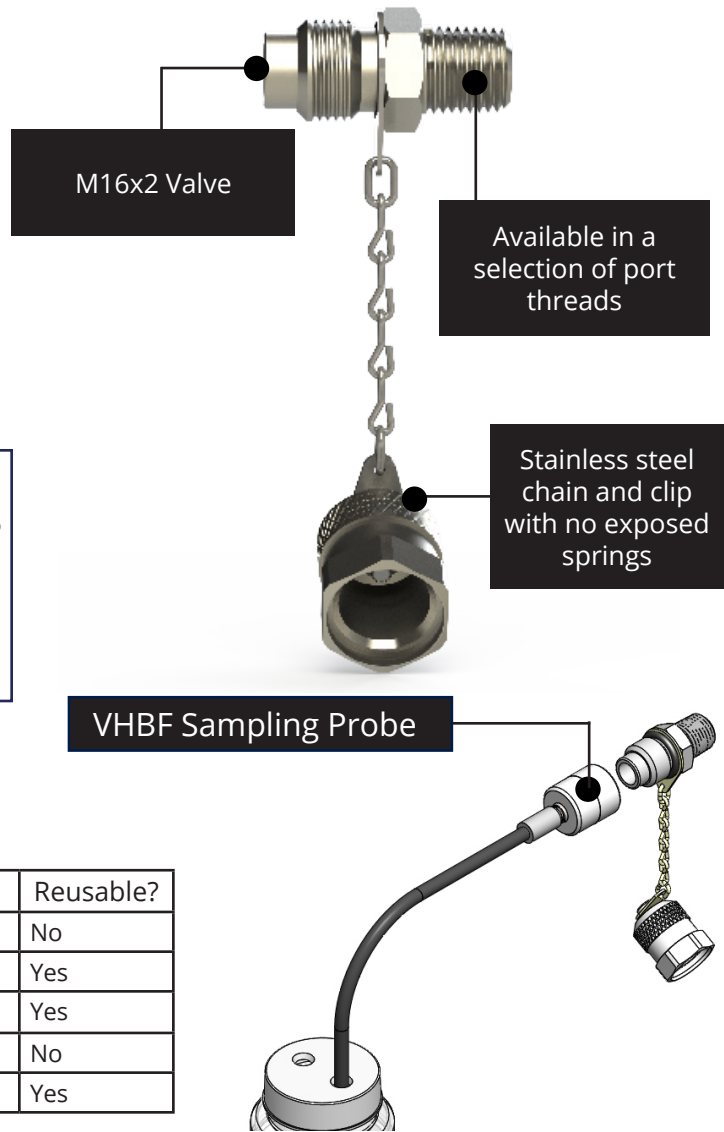

### Required for Sampling:

Part	Use	Reusable?
SBF4-K2	Sampling probe for pressures below 100 psi	No
SBF4	Sampling probe for pressures below 125 psi	Yes
VHBF	Sampling probe for pressures above 125 psi	Yes
SER4	Plastic tubing (if using SBF4)	No
VAC	Vacuum pump (if using SBF4)	Yes

Part Number	Port Thread Size and Type	Valve Sealing	Valve Material
B14N	1/4"-18 NPTF	Nitrile	Carbon Steel
B14NV	1/4"-18 NPTF	Viton	Carbon Steel
B14N-R	1/4"-18 NPTF	Nitrile	Stainless Steel
B14N-RV	1/4"-18 NPTF	Viton	Stainless Steel

**Note:** Other thread sizes available  
Valve Material Options: Carbon Steel, 316 Stainless Steel

For Gearboxes and Reservoirs we suggest Checkfluid's LT or LTJ Series

## L Series

0 - 125 psi (0.03 - 0.86 MPa)

### Benefits

- Samples 7x faster than the B16x2 series
- **Easy to clean flat face designed**
- **Extra compact**
- Elastomeric sealing to withstand 27 in Hg system working pressure
- Sample without shutting the equipment down

### Bearings

High flow, flushed face valve designed to sample high viscosity gear oils up to VG 1500

Corrosion resistant stainless steel chain and clip

Variety of thread options for direct installation

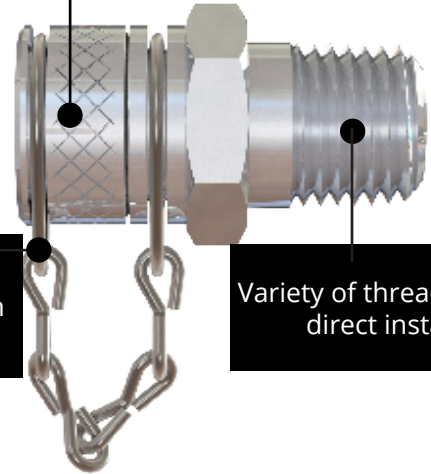

### SLF4 Sampling Probe

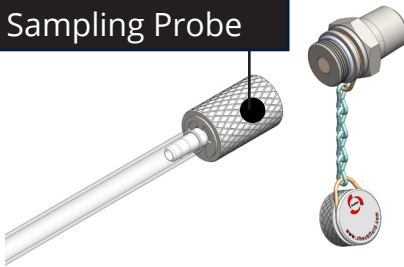

### Required for Sampling:

Part	Use	Reusable?
SLF4	Sampling probe for 1/4" OD tube	Yes
SER4	Plastic tubing	No
VAC	Vacuum pump	Yes

Part Number	Port Thread Size and Type	Valve Sealing	Valve Material
L14N-C	1/4"-18 NPTF	Viton	Carbon Steel
L14NR-C	1/4"-18 NPTF	Viton	316 Stainless Steel
L6U-C	9/16"-18 ORB	Viton	Carbon Steel
L6UR-C	9/16"-18 ORB	Viton	316 Stainless Steel
L4GD-C	1/4"x19 BSPT	Viton	Carbon Steel

**Note:** also available in other BSPT threads, different tube lengths also available  
Valve Material Options: Carbon Steel, 316 Stainless Steel, 304 Stainless Steel

For Gearboxes and Reservoirs we suggest Checkfluid's LT or LTJ Series

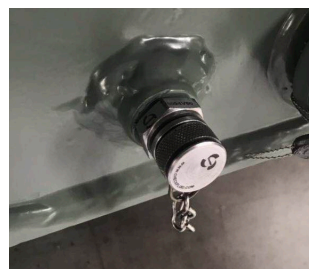
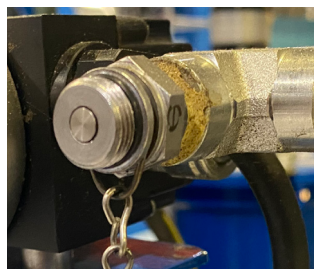

## LE Series

0 - 125 psi (0.03 - 0.86 MPa)

## Benefits

- Compact - only 0.64" (16mm) clearance required
- **Sampling valve can be inserted into drain or level plug**
- A wide variety of threads are available
- Allows sampling without removing the drain plug
- Can safely vent the system prior to servicing

## LE Options

- Optional high strength magnet remove damaging ferrous wear debris from the oil with each wheel rotation
- Optional bent sampling tube to sample away from bottom and side sediment

## Final Drives

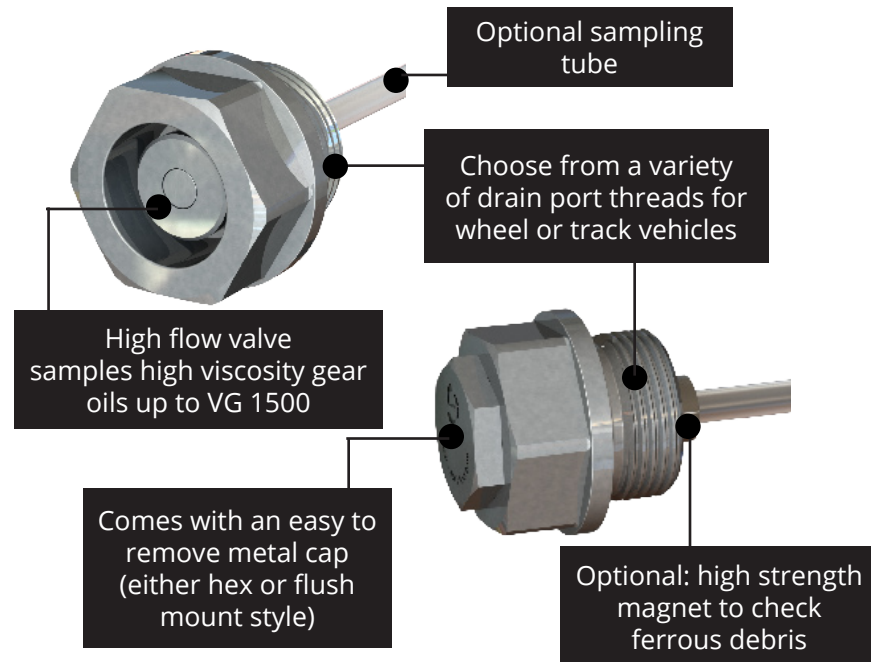

## Required for Sampling:

Part	Use	Reusable?
SLF4	Sampling probe for 1/4" OD tube	Yes
SER4-100	Plastic tubing (100 ft)	No
VAC	Vacuum pump	Yes

Part Number	Port Thread Size and Type	Valve Sealing	Valve Material
LE12N	3/4"-14 NPTF	Viton	Carbon Steel
LE24N	1 1/2"-11.5 NPTF	Viton	Carbon Steel
LE2215M	M22x1.5	Viton	Carbon Steel
LE2415M	M24x1.5	Viton	Carbon Steel

**Notes:** for part numbers with tube or magnet please contact us  
 More port thread size and types are available  
 Tube lengths are customized (1.5" - 3")



## Mounting Options

### Inline Connectors

- Add or replace inline connectors at existing hose or tube fitting locations for safe, convenient access.
- Reduces sample valve install times by up to 80%
- To order with valve, drop 4UF in part # & add valve L, KP, or KST series (e.g. KP-6J-6JF)
- Connectors are rated up to 4500 psi

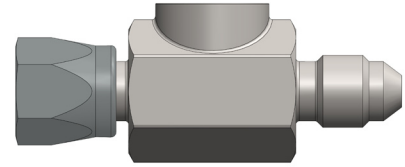

Part #	Description
4J-4JF-4UF	7/16" - 20 ORB Fem to 7/16" - 20 JIC to 7/16" - 20 JIC Fem Inline
6J-6JF-4UF	7/16" - 20 ORB Fem to 9/16" - 18 JIC to 9/16" - 18 JIC Fem Inline
6U-6J-4UF	Adapter 9/16" - 18 ORB to 9/16" - 18 JIC
4F-4FF-4UF	Inline Adapter, -4 ORFS to -4 ORFS Fem with -4 ORB Port

**Note:** not all part numbers are listed

### Port Adapters

- Add a valve directly to the port best suited for sampling
- Choose from a wide range of BSPP, BSPT, SAE, NPTF and metric thread adapters

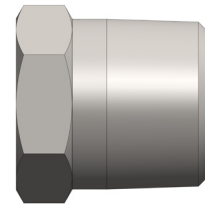

Part #	Description
4UF-4N	Adapter, 7/16" - 20 ORB to 1/4" - 18 NPTF
4UF-6N	7/16" - 20 ORB Fem to 3/8" - 18
4UF-2GC	7/16" - 20 ORB Fem to 1/8" - 28 BSPP
4UF-4NF	7/16" - 20 ORB Fem to 1/4" - 18 NPTF, Fem
4UF-10125MB	7/16" - 20 ORB Fem to M10x1.25, DIN 2353

**Note:** not all part numbers are listed

### Tees

- Replace a straight or elbow connection with a tee

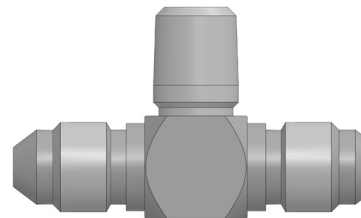

Part #	Description
4J-4NF-4J	Adapter -4 JIC to -4NPTF fem to -4 JIC Tee
4NF-4NF-4N	Adapter, 1/4" -18 NPTF Branch Tee
4U-4UF-4UF	Tee Adapter, -4 ORB to -4 ORB Fem with -4 ORB Fem Branch
6J-6J-4NF	Adapter -6JIC to -6JIC to -4NPTF fem tee

**Note:** not all part numbers are listed

# Sampling Tubes



## LT Sampling Tube

0 - 125 psi (0.03 - 0.86 MPa)

### NPT/BSPT Style

#### Gearboxes | Reservoirs

#### Benefits

- Samples 7x faster than the M16x2 style
- Zinc-nickel based corrosion protection offers 5 - 7x more life than the industry standard
- Sample without shutting the equipment down
- **Easy to clean L High Flow flush face valve decreases the chance contamination**
- Vacuum suction the active gear oil out with vacuum pump and plastic tubing
- For extra high viscosity (VG460+) up-size to the 5/16" OD Tube

High Flow flush face valve designed to sample up to VG1500

Rigid style displayed but swivel option is available

Sampling tube draws only oil from the active zone

Stainless steel chain and clip with no exposed springs

Available in 1/4"-18 NPTF and 1/4"x19 BSPT port threads

#### Required for Sampling:

Part	Use	Reusable?
SLF4	Sampling probe for 1/4" OD tube	Yes
SLF5	Sampling probe for 5/16" OD tube	Yes
SER4-100	Plastic tubing (100 ft)	No
VAC	Vacuum pump	Yes

Part Number	Port Thread Size and Type	Valve Sealing	Valve Material	Tube Size	Tube Material	Swivel	Tube Length
L14NTR12	1/4"-18 NPTF	Viton	Carbon Steel	1/4" OD	Stainless Steel	No	12"
L14NRTR12	1/4"-18 NPTF	Viton	Stainless Steel	1/4" OD	Stainless Steel	No	12"
L14N5TR12	1/4"-18 NPTF	Viton	Carbon Steel	5/16" OD	Stainless Steel	No	12"
L14NR5TR12	1/4"-18 NPTF	Viton	Stainless Steel	5/16" OD	Stainless Steel	No	12"

**Notes:** also available in 1/4"x19 BSPT threads, different tube lengths, and swivel option also available  
Valve Material Options: Carbon Steel, 316 Stainless Steel, 304 Stainless Steel

**For more thread sizes check out the LTJ Series**

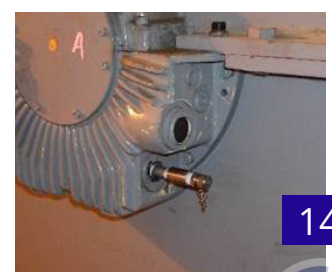
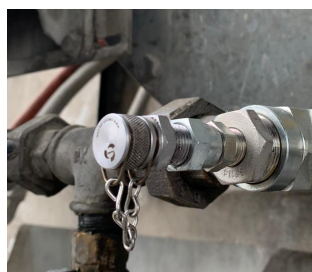

## LTJ Sampling Tube

0 - 125 psi (0.03 - 0.86 MPa)

### Universal Style

#### Gearboxes | Reservoirs

#### Benefits

- Sample high viscosity gear oils without shutting down
- Samples 7x faster than the M16x2 style
- Zinc-nickel based corrosion protection offers 5 - 7x more life than the industry standard
- **Installs compactly into almost any port without special tools or multiple adapters**
- Easy to clean L High Flow flush face valve decreases the chance of contamination
- For extra high viscosity (VG460+) up-size to the 5/16" OD Tube

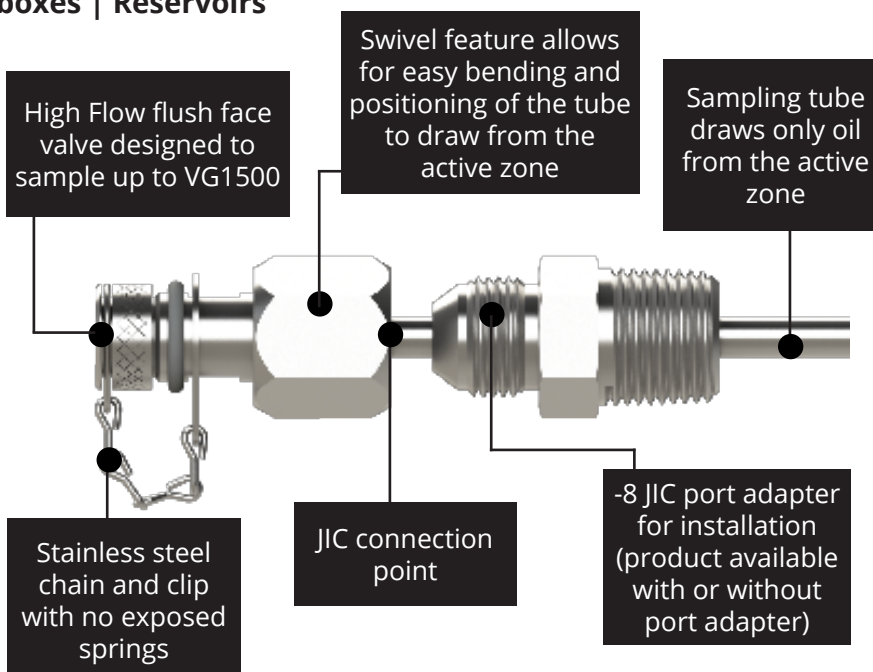

#### Required for Sampling:

Part	Use	Reusable?
SLF4	Sampling probe for 1/4" OD tube	Yes
SLF5	Sampling probe for 5/16" OD tube	Yes
SER4-100	Plastic tubing (100 ft)	No
VAC	Vacuum pump	Yes

Part Number	Port Adapter Included?	Port Thread Size and Type	Valve Sealing	Valve Material	Tube Size	Tube Material	Swivel	Tube Length
L8JFSTRS12	No	-8 JIC Fem	Viton	Carbon Steel	1/4" OD	Stainless Steel	Yes	12"
L4NTRS12	Yes	1/4"-18 NPTF	Viton	Carbon Steel	1/4" OD	Stainless Steel	Yes	12"
L8NTRS12	Yes	1/2"-14 NPTF	Viton	Carbon Steel	1/4" OD	Stainless Steel	Yes	12"
L16NTRS12	Yes	1"-11.5 NPTF	Viton	Carbon Steel	1/4" OD	Stainless Steel	Yes	12"

**Notes:** different port sizes available, different tube lengths also available  
Valve Material Options: Carbon Steel, 316 Stainless Steel

**Acrylic sight option also available**



## LTJ Sight Sampling Tube

0 - 65 psi (0.03 - 0.45 MPa)

### Gearboxes | Reservoirs

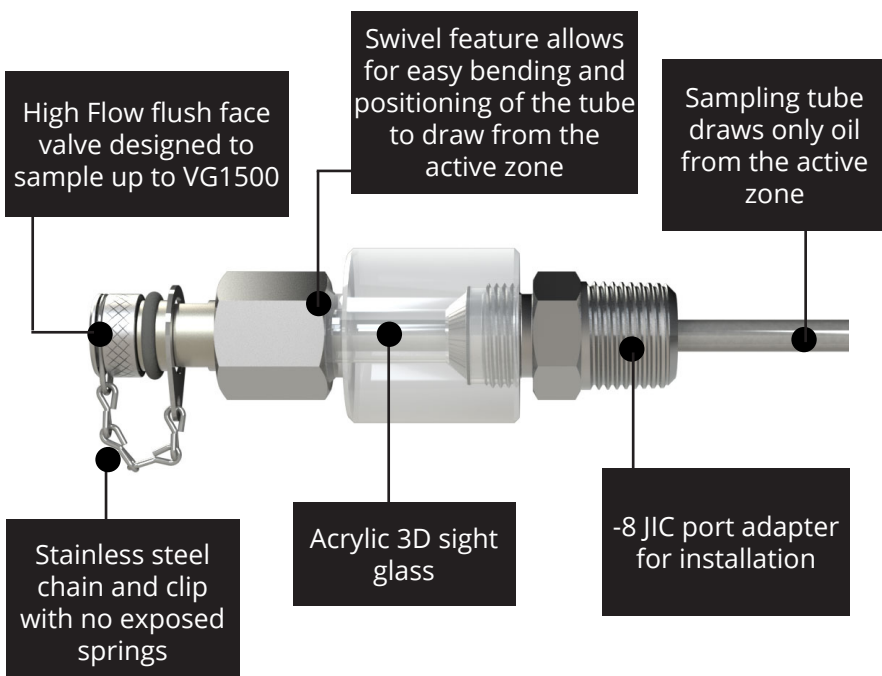

### All the great benefits of the LTJ sampling tube plus:

- Detect oil levels more accurately and from any angle with the 3D sight glass
- Visually check for any oil discoloration

### What you get with the LTJ Sight:

- Accurate oil detection
- Ability to view oil from multiple angles
- Ability to sample high viscosity oils
- Quicker samples
- Best representative samples

### Required for Sampling:

Part	Use	Reusable?
SLF4	Sampling probe for 1/4" OD tube	Yes
SLF5	Sampling probe for 5/16" OD tube	Yes
SER4-100	Plastic tubing (100 ft)	No
VAC	Vacuum pump	Yes

Part Number	Port Thread Size and Type	Valve Sealing	Valve Material	Tube Size	Tube Material	Swivel	Tube Length
L12NATRS12	3/4" NPT	Viton	Carbon Steel	1/4" OD	Stainless Steel	Yes	12"
L16NATRS12	1" NPT	Viton	Carbon Steel	1/4" OD	Stainless Steel	Yes	12"
L12GCATRS12	3/4" BSPP	Viton	Carbon Steel	1/4" OD	Stainless Steel	Yes	12"
L6GCATRS6	3/8" BSPP	Viton	Carbon Steel	1/4" OD	Stainless Steel	Yes	12"

**Notes:** port adapter included, different tube lengths and port sizes also available  
Valve Material Options: Carbon Steel, 316 Stainless Steel

## BT Sampling Tube

0 - 500 psi (0.03 - 3.45 MPa)

### Gearboxes | Reservoirs

#### Benefits

- Euro-Probe sampling valve uses M16x2 probes
- Easily bend tube to capture active oil in reservoirs and gearboxes
- Swivel option available for easy installs when bending tubes
- **Sampling range 0 - 500 psi (0 - 3.45 MPa)**

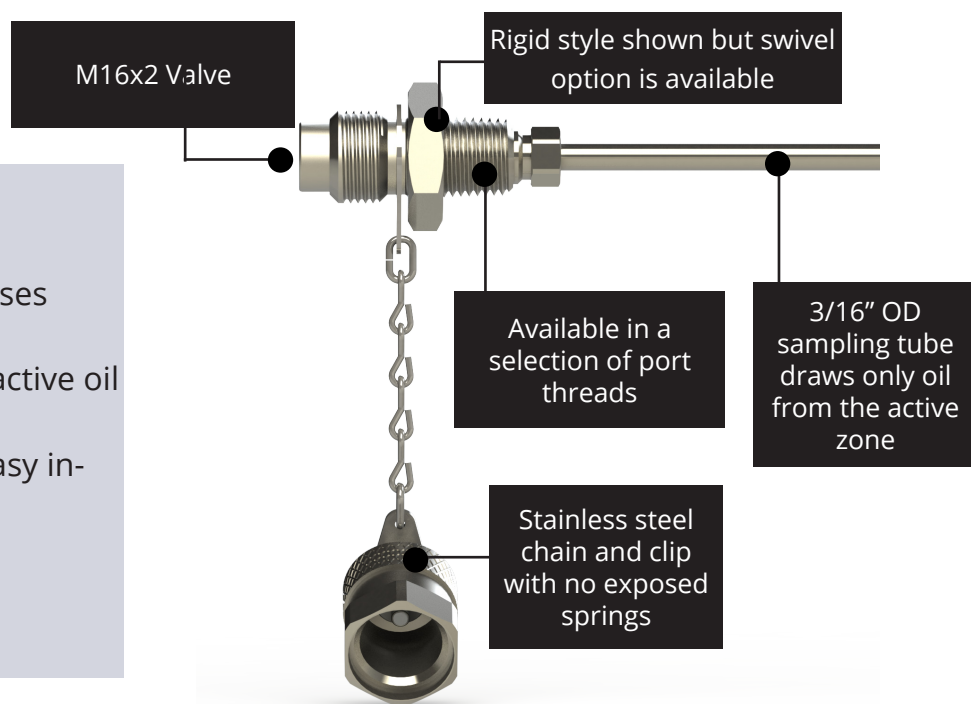

**For a higher flow sampling consider the LT or LTJ Sampling Tubes**

#### Required for Sampling:

Part	Use	Reusable?
SBF4	Sampling probe for pressures below 125 psi	Yes
VHBF	Sampling probe for pressures above 125 psi	Yes
SER4	Plastic tubing	No
VAC	Vacuum pump	Yes

### Gearboxes | Reservoirs

Part Number	Port Thread Size and Type	Valve Sealing	Valve Material	Tube Size	Tube Material	Swivel	Tube Length
B14NTR12	1/4"-18 NPTF	Viton	Carbon Steel	3/16" OD	Stainless Steel	No	12"
B14NTRS12	1/4"-18 NPTF	Viton	Carbon Steel	3/16" OD	Stainless Steel	Yes	12"
B14NRTR12	1/4"-18 NPTF	Viton	Stainless Steel	3/16" OD	Stainless Steel	No	12"
B14NRTRS12	1/4"-18 NPTF	Viton	Stainless Steel	3/16" OD	Stainless Steel	Yes	12"

**Note:** Other thread sizes available, different tube lengths also available  
Valve Material Options: Carbon Steel, 316 Stainless Steel

# Condition Monitoring Tools

Incorporating condition based monitoring tools in with your oil sampling valves will only help you increase savings. Condition based monitoring versus time based monitoring enable a company to complete necessary maintenance when it is needed rather than when it is scheduled.

The easiest way to incorporate additional condition monitoring tools along side your sampling valves is through introducing visual oil inspections. Visual oil inspections can be done by the operator at the equipment with little to no training. Adding visual oil analysis along with sampling to your current program can allow you to detect problems even before your scheduled oil sample. Visual oil analysis tools such as sight glasses, and level gauges play an important role in early detection of contamination and other oil problems. They provide continuous fluid monitoring of the clarity, colour, sediment, and water contamination of the oil. For example, a bottom sediment and water bowl can be used to find the presence of water before it impacts your machine and before your next scheduled sampling time.

Desiccant breathers offer front line defence against particle detection. As air is drawn into the equipment, the desiccant filter elements remove particles while the beads stop harmful moisture.



## AB Breather Mount

0 - 125 psi (0.03 - 0.86 MPa)

Optimize the breather port with an AB Mount. Mount a desiccant breather, a fill port, a filter minder, sampling tube and a return vent line while maintaining a closed system. Combined with the AD Mount for a complete fluid maintenance system [The CORE Solution].

Option to add a High Flow Sampling Valve if not combining with the AD Drain Mount

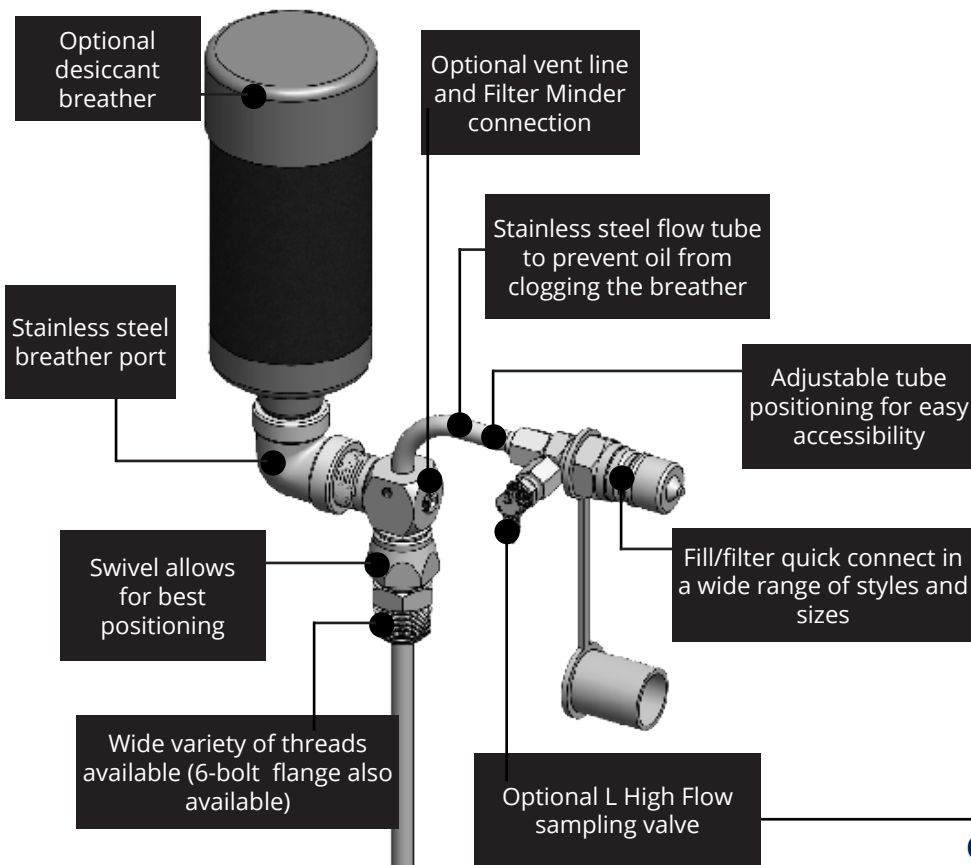

- Optional desiccant breather offers better filtration to protect against moisture and particulates that can destroy your system
- Optional high flow sampling valve allows you to get reliable oil samples directly from the active oil zone
- Add an Oil Mist Coalescer (OMC) with a 5" stainless pipe riser which helps elevate the desiccant breather and minimize premature clogging of the desiccant breather
- Port thread adapter or 6-bolt flange provides a variety of options to fit most gearboxes/reservoirs

AB Options Not Shown:

- Oil Mist Coalescer
- Filter Minder

### Optional 6-Bolt Flange Mount

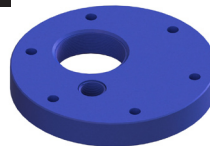

- AB16 Flange Breather Mount
- Rugged aluminium base combines fluid monitoring with one 6-bolt breather mount

Part Number	Port	Port Adapter Size	Quick Connect Size	Plugged Port	Tube Length	Tube OD	Tube Material
ABQ16-16N	Breather	1" NPTF	3/4" ISO B	Yes	12"	1/2"	Stainless Steel
AB16-16N	Breather	1" NPTF	1/2" ISO B	Yes	12"	1/2"	Stainless Steel

Other custom options are also available

## AB Breather Mount Accessories

### Oil Mist Coalescer (OMC)

What it does:

- Oil mist from equipment, especially when running over 60°C, can cause your desiccant filter layer to plug resulting in a pressure build-up
- If your breather is showing sign of reddish or brown darkening at the top filter layer, consider adding our OMC option to pre-filter the air
- The OMC's metal mesh helps bead the oil to return to tank to prevent clogging and prolong the life of the breather

Part #	Description
OMC	Oil Mist Coalescer, 5" Riser, 1" NPT Connection Thread
OMCF	Oil Mist Coalescer, 5" Riser, 1" NPT Female Connection Thread

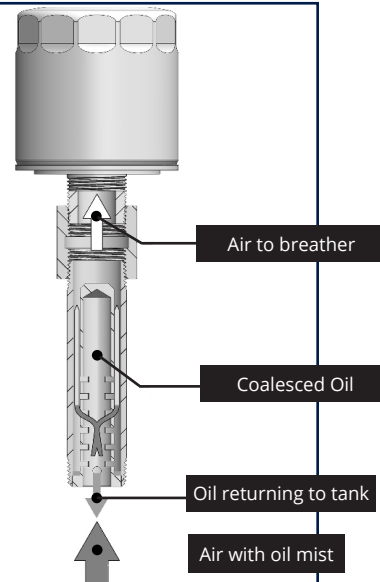

### Filter Minder™

What it does:

- Gauges such as a colour coded Filterminder™ help as it indicates when a desiccant filter should be changed
- The gauge provides an indication of the built-up pressure in the oil vessel that can cause seal damage or blowout, friction, overheating and loss of power
- Remember if you desiccant filter is clogged it might not change colour to identify it needs to be replaced

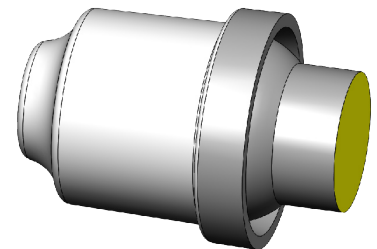

Part #	Description
GV25	25" Hg Gauge 1/8" Pipe Thread, Filter Minder
GV25-4N	25" Hg Gauge 1/8" Pipe Thread, Filter Minder, 1/4" NPT Connection Thread

### Desiccant Breather

What it does:

- Desiccant breathers prevent moisture contaminated air and particles from entering your system
- The clear outer shell provides a visual indicator of the condition of the breather
- In humid environments breathers may require more frequent change out - the CV (check valve) can help extend out breather life if this is an issue

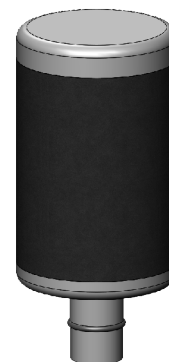

Part #	Description
D-4	Des-Case Standard Desiccant Breather, 10" Height with 1" Multi-Fit Connection
DT-4	Power Breather, Size 4, Orange Silica Gel, 1" NPT Connection

Other Desiccant Breather sizes available. CV option available for Power Breathers only (DT-4-CV)

## AD Drain Mount

0 - 125 psi (0.03 - 0.86 MPa)

The AD Drain Mount allows for installation of a permanent sampling tube into the drain port. The sampling tube is bent or positioned to reach the active zone, ensuring the sample is taken away from the bottom or side sediment. The AD includes a quick connect with the option to add a level gauge, or bottom sediment & water sight glass.

- Combines sampling with draining or filtration features from one port
- Able to get a clean, accurate sample from the active zone
- Provides a clean permanent drain or filter cart connection

### Visual Oil Analysis Options

#### Brass/Glass Level Gauge [Pictured]

- Glass level provides 120° viewing
- Available in 3", 6", 9" and 12" lengths

#### Acrylic Level Gauge

- Acrylic vertical levels provide 360° view
- Minimizes the risk of breakage
- Available in 3", 6", 9" and 12" lengths

#### Bottom Sediment & Water (BSW) [Pictured]

- Visually inspect and monitor the rate of accumulation of water, or sediment

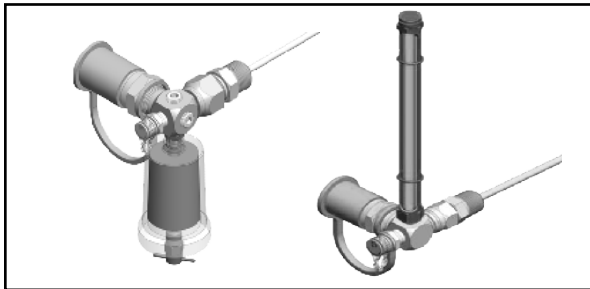
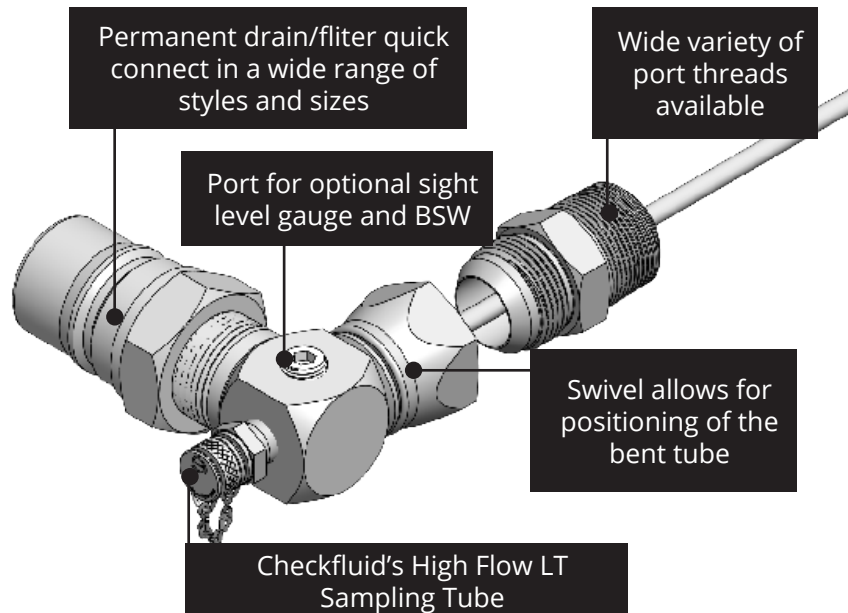

### Required for Sampling:

Part	Use	Reusable?
SLF4	Sampling probe for 1/4" OD tube	Yes
SLF5	Sampling probe for 5/16" OD tube	Yes
SER4-100	Plastic tubing (100 ft)	No
VAC	Vacuum pump	Yes

Part Number	Port	Port Adapter Size	Quick Connect Size	Plugged Port	Tube Length	Tube OD	Tube Material
AD16-16N	Drain	1" NPTF	1" ISO B	Yes	12"	1/4"	Stainless Steel
AD12-12N	Drain	3/4" NPTF	3/4" ISO B	Yes	12"	1/4"	Stainless Steel

**Note:** Contact for more information and pricing on breathers, sight levels, gauges, BSW etc  
Available in a variety of sampling tube lengths and port sizes



## AC Mount

0 - 125 psi (0.03 - 0.86 MPa)

Install the AC on a compact gearbox or reservoir, in a mid-level. Visually check the fluid level or colouration. Position the tube to reach the oil in the action zone for precision sampling.

- Draw a clean, accurate sample from the active zone
- Sample without shutting the equipment down
- Easy to clean L high-flow flush-face valves decreases the chance of cross contamination

### Level Gauge Options

Brass/Glass Level Gauge [Pictured]

- Glass level provides 120° viewing
- Available in 3", 6", 9" and 12" lengths

Acrylic Level Gauge

- Acrylic vertical levels provide 360° view
- Available in 3", 6", 9" and 12" lengths

### Bottom Sediment & Water Bowl Option

- View water or sediment that has collected at the bottom

Checkfluid's High Flow  
LT Sampling Tube

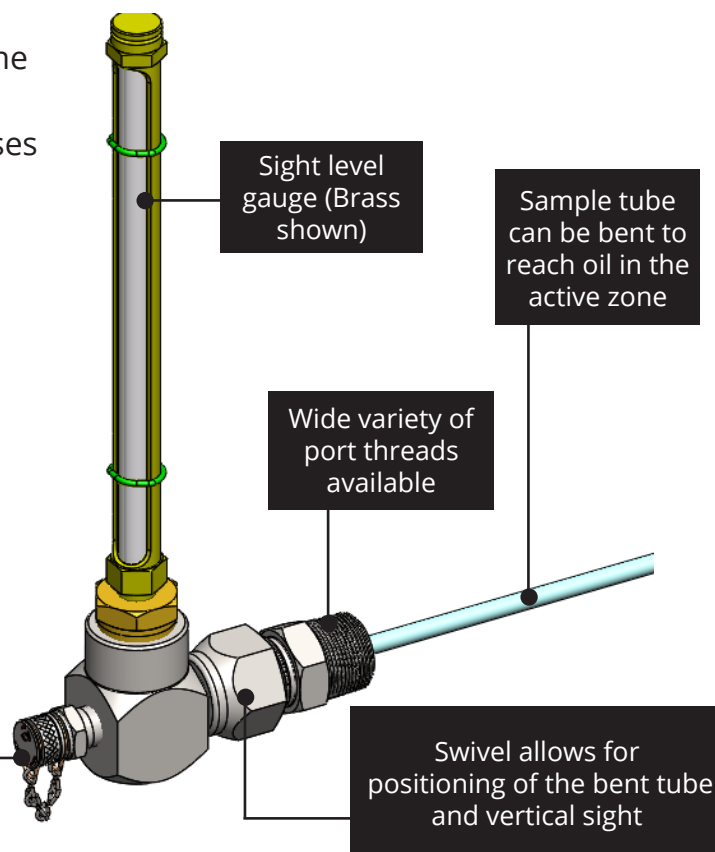

### 3D BullsEye Option

3D BullsEye

- Quick oil level inspection
- Easily view oil level with 360° view bull's-eye offers

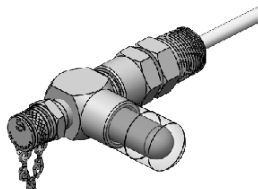

### Required for Sampling:

Part	Use	Reusable?
SLF4	Sampling probe for 1/4" OD tube	Yes
SLF5	Sampling probe for 5/16" OD tube	Yes
SER4-100	Plastic tubing (100 ft)	No
VAC	Vacuum pump	Yes

Part Number	Port Adapter Size	Sight Option	Sampling Tube
AC8-6N-GL6	3/8" NPTF	6" Brass Gauge	12" Stainless Steel Tube
AC8-8N-GLV9	1/2" NPTF	9" Brass Gauge with Breather Vent Line	12" Stainless Steel Tube

**Note:** All options not shown -Contact for more information on other configurations  
Available in a variety of sampling tube lengths and port sizes

## AD & AC Mount Accessories

### Oil Level Gauges

What it does:

- Allows you to monitor the oil level in your machine
- Maintaining the correct level is essential as oil lubricates, cools and protects the moving parts of your machine
- Side or top installation available
- Vent kit option available for connection to the AB. This provides a completely enclosed system, preventing outside contaminants from entering the system



Part #	Description
GL9S	9" Brass Oil Sight, No Vent Kit, Side Mount, 1/2" OD Glass
GL9	Level Gage, 9", 1/4" - 18 NPT, Brass, 1/2" OD Glass
GLV9S	9" Brass Oil Sight w/ Vent Kit, Side Mount

3", 6", 12" sizes, and acrylic options also available

### Bottom Sediment & Water Bowl

What it does:

- Visually inspect for dirty oil, water contamination or excessive wear debris
- It is UV resistant
- It is extremely durable - the inherently strong polyamide material will withstand the toughest environments
- Allows free water to be easily drained from the system

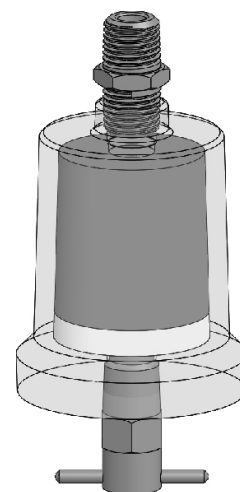

Part #	Description
COSG1X250	Oil Sight Glass (Bottom Sediment & Water Glass), 1 oz, 1/4" NPT
COSG3X250	Oil Sight Glass (Bottom Sediment & Water Glass), 3 oz, 1/4" NPT

### 3D Sight Glass

What it does:

- Quick oil level inspection
- Easy to see oil level with 360° view bull's-eye offers
- Replaces brass & glass, flush-mounted sight windows for better viewing
- Meets space limitations
- Installs in minutes

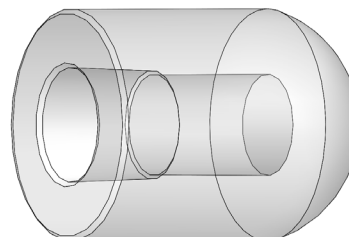

Part #	Description
C3DB0250	3D Bulls Eye Sight Glass, 1/4" NPT, Acrylic
C3DB0250K	3D Bulls Eye Sight Glass, 1/4" NPT, Transparent Polyamide

More port sizes available

## The CORE Solution

0 - 125 psi (0.03 - 0.86 MPa)

Desiccant Breather

Quick Coupling for  
Filtering and Filling

Vent Line

Brass Level  
Gauge

Quick Coupling for  
draining & filter  
cart connection

High Flow LT  
Sampling Tube

Bottom Sediment &  
Water Bowl

The AB and AD adapters join together as the CORE to condition monitor oil levels, free water and sediment levels, changes in coloration, and desiccant breather performance. The CORE is ready to provide a clean hook-up to fast off-line filtration to a level needed to extend equipment life and optimize performance. The condition monitoring process is not complete without precision Checkfluid sampling providing the representative repeatable fluid sample data you need to make those important management decisions, quickly and confidently.

### With the CORE Solution you can:

- Get best practice oil samples
- Drain your oil
- Perform in-service filtering through a closed system
- Complete visual oil analysis inspections
- Protect your system from particles and moisture contamination
- Perform easy oil top ups and fills

Accessories you can incorporate into the CORE Solution:

- Level gauge (Brass or Acrylic)
- Bottom Sediment & Water Bowl
- Desiccant Breather
- Filter Minder
- Oil Mist Coalescer

### How to Order the CORE Solution:

Ordering the CORE is easy, simply order both a AB & AD Mount. If you would like to include any CORE accessories please contact Checkfluid

#### Standard Option:

Part Number	Port	Port Adapter Size	Quick Connect Size	Plugged Port	Tube Length	Tube OD	Tube Material
ABQ16-16N	Breather	1" NPTF	3/4" ISO B	Yes	12"	1/2"	Stainless Steel
AD16-16N	Drain	1" NPTF	1" ISO B	Yes	12"	1/4"	Stainless Steel

Part Number	Port	Port Adapter Size	Quick Connect Size	Plugged Port	Tube Length	Tube OD	Tube Material
AB16-16N	Breather	1" NPTF	1/2" ISO B	Yes	12"	1/2"	Stainless Steel
AD12-12N	Drain	3/4" NPTF	3/4" ISO B	Yes	12"	1/4"	Stainless Steel

**Notes:** Contact Checkfluid for more information and pricing on AD & AB Accessories  
Other AB & AD Sizes available

## Drum Adapter

0 - 125 psi (0.03 - 0.86 MPa)

A successful condition monitoring begins at the start with your new and incoming oil. Cleanly store, monitor and transfer your incoming oil with Checkfluid's Drum/Tote Adapter.

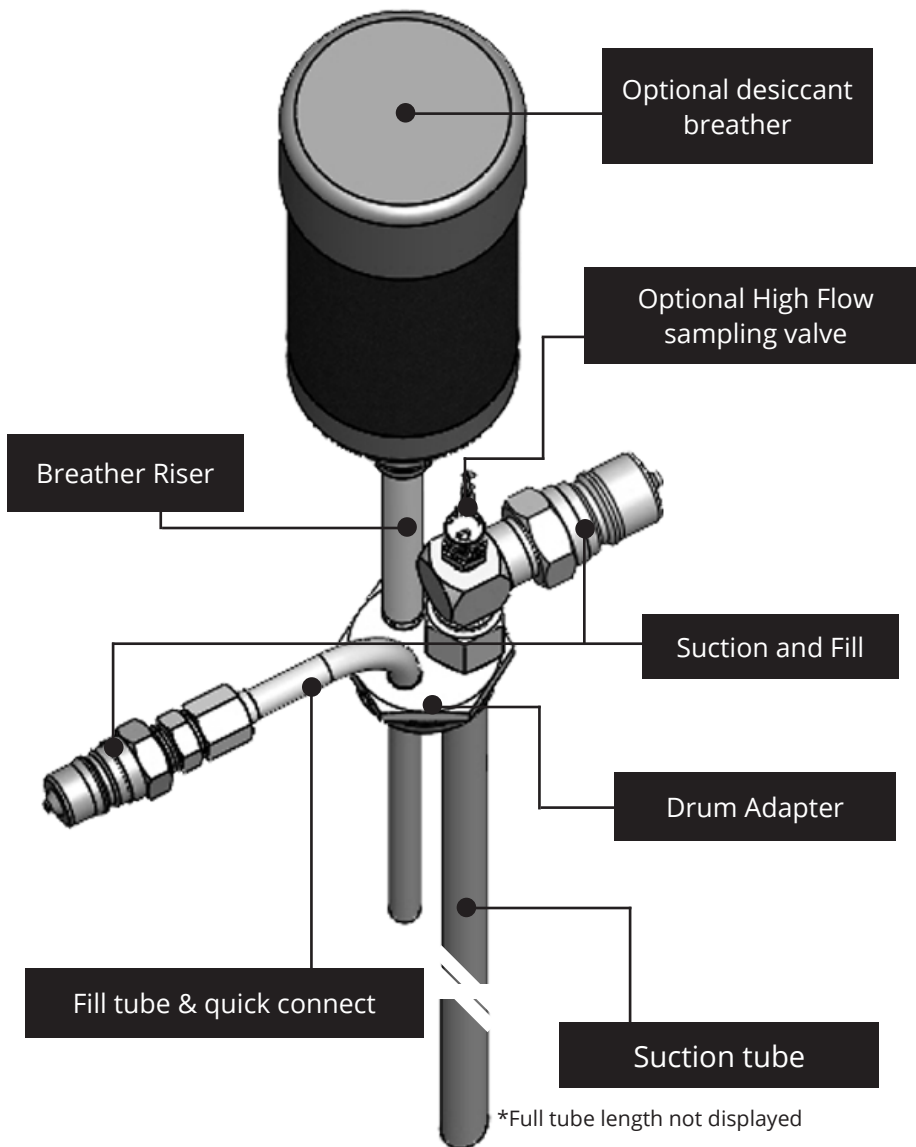

### Clean your new/stored oil

- Cleanly connect your drum or tote to your filtration system to filter your new/stored oil
- Optional flush face coupling provide a better option that keeps the work area cleaner

### Monitor your new/stored oil

- High flow sampling valve option allows you to continually check on your oil without opening the drum up to external contamination
- Optional desiccant breather provides additional protection from moisture and particulate contamination
- Secure connection prevents the entry of dirt and moisture

### Transfer your new/stored oil

- Cleanly connect to transfer containers via quick connects
- Closed transfer system reduces the risk of contaminants getting in

Part Number	Port Adapter Size	Suction QB	Fill QB	Suction		Fill		Tube Material
				Length	OD	Length	OD	
DR1612XX	2" NPT	1" ISO B	3/4" ISO B	*36"	3/4"	12"	1/2"	Stainless Steel
DR128XX	2" NPT	3/4" ISO B	1/2" ISO B	*36"	3/4"	12"	1/2"	Stainless Steel

\*40" tube available for Totes  
Other custom options are also available

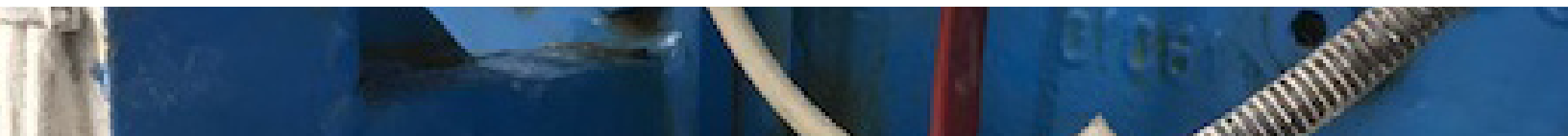

**Presented by Zudak Solutions**

Zudak Solutions | P: 678-383-5479 | E: [support@zudaksolutions.com](mailto:support@zudaksolutions.com)



**ZUDAK**  
**SOLUTIONS**